

## SWIMSTART BATTERY REPLACEMENT

The battery on the SWIMSTART is not specifically designed to be replaced by the user. However, if your SWIMSTART's 5 year warranty (2 years on battery) has expired, you may want to try it yourself. **PLEASE NOTE: On some older starts, the battery is wired differently than described below. Observe how the battery is connected and install the new ones the same way.**

You will need:

- 1 12-volt, rechargeable, lead-acid battery with Faston spade connectors. This battery is available from IST for \$35.00 or you can purchase them locally. This model is widely used and should be available from any battery vendor. Take the old battery with you to make sure you get the right model. The vendor may also recycle the old battery for you.
- A large Phillips screwdriver



1. Loosen the wing nut on the speaker and remove the speaker from the bracket.
2. See picture 2—white arrow. Remove the 4 Phillips screws from the corners of the speaker-side plate. Corrosion may make this difficult. Using a penetrating spray like WD40 may help. There are 2 red wires that attach the plate to the internal circuit board. DO NOT put strain on the wires or you might loosen the connections.
3. Slide the black face plate to the right and set it aside.
4. See picture 2—white arrow. Carefully slide the circuit board to the right, disengaging the socket from the left side plate, and set it aside.
5. See picture 3—black arrow. There is a black grommet strip on the top edge of the circuit board that helps keep it tight. Be sure you don't lose it. You will now be able to see the battery.
6. See picture 3—white arrow. Slide the spade connectors off of the battery terminals. Note the orientation of the terminals on the left end of the battery.
7. See picture 3—black arrow. Locate the Phillips screw on the back of the start case that screws into the nut on the battery hold-down strap and remove it. You can now remove the old battery.
8. Put in the new battery, keeping the orientation of the terminals to the left, the same as the old ones.
9. Replace the hold-down bracket and screw in place.
10. Replace the terminal cables, making sure the black wire connects to the black terminal and the red wire connects to the red terminal. You should feel the connector snap into place.
11. Replace the circuit board, making sure that the grommet strip is in place and the connector on the left side is firmly seated in the socket on the side plate.
12. Before replacing the front plate, you might want to give it a thorough cleaning with a soft cloth and glass cleaner or a solution of white vinegar and water.
13. Slide the face plate back into its channels.
14. Replace the side plate with the 4 screws, making sure the red wires are safely tucked inside.
15. Replace the speaker on its mounting bracket
16. Before using the SWIMSTART again, **you must charge it for 12 hours.**



Picture 1

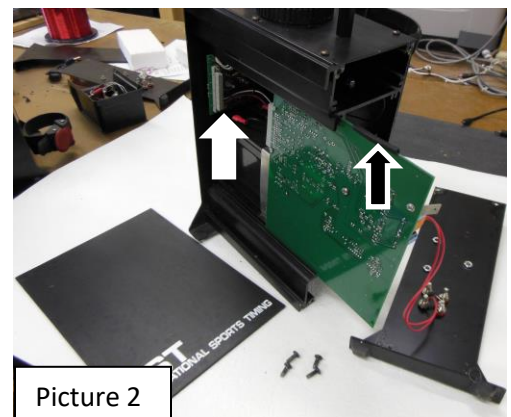

Picture 2

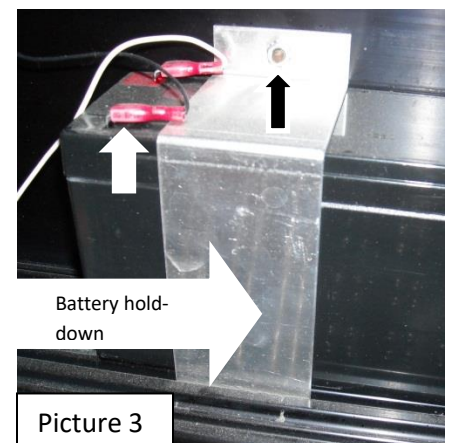

Picture 3

If you have any problems replacing the battery, feel free to call IST at 800/835-2611 for assistance.